

# Autodesk® Navisworks® 2016 Service Pack 1

Guide to features and enhancements

April 2015

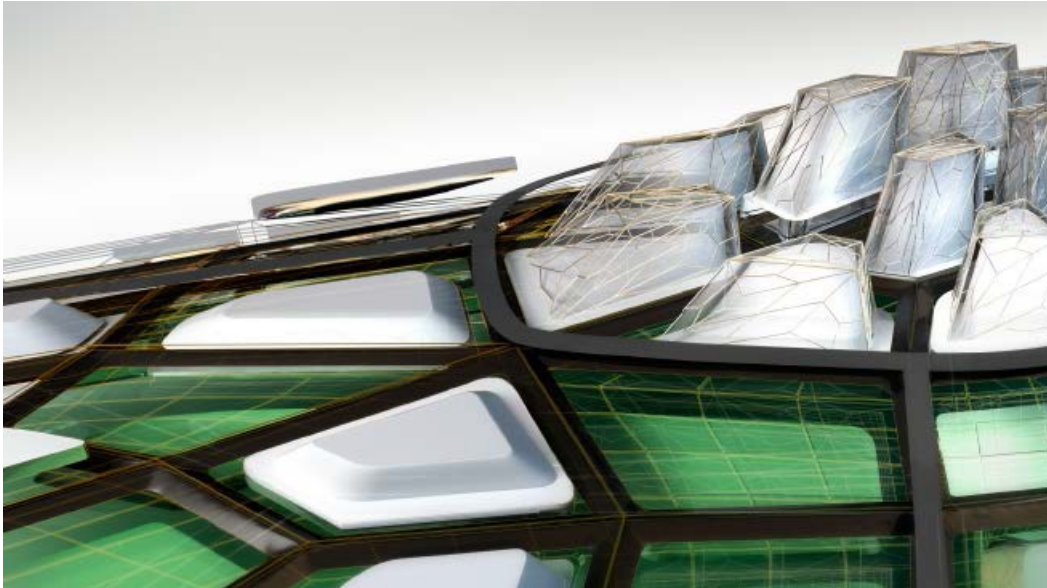

Please send feedback on this guide to: [navisworks.productmanager@autodesk.com](mailto:navisworks.productmanager@autodesk.com)

# Contents

- Guide to features and enhancements .....1
  - April 2015 .....1
- Introduction .....3
- Primary issues resolved by the Service Pack .....4
  - Exporters .....4
  - Merged Models.....4
  - NWC Export.....4
  - Roamer .....4

## Introduction

Thanks for downloading Autodesk® Navisworks® 2016 Service Pack 1. This document provides a quick summary of the new features and enhancements that are included in our Service Pack.

Please remember to fully review the **Installation Readme** document before you apply the Autodesk Navisworks Service Pack 1 to your product. During installation, you may be prompted for the original installation media or a network image. In order to apply this Service Pack, you must have administrative privileges to install and uninstall products.

We want to express our appreciation to all our customers who identified the issues we have addressed in this Service Pack release. Their reports gave us the opportunity to improve the product and to provide you with the best solution. We also thank you for your continued business, and for your feedback about this release.

Many thanks,

**The Navisworks Team**

## Primary issues resolved by the Service Pack

Autodesk Navisworks 2016 Service Pack 1 provides the following fixes and enhancements:

### Exporters

- Resolved an issue where installation of Brazilian Portuguese (pt-BR) language pack was failing.
- Resolved an issue where English UI was displayed when uninstalling the Spanish (ES) and French (FR) 32 bit exporter.

### Merged Models

- Resolved an issue where a Merged Model created in Glue Desktop cannot be opened in Navisworks.
- Resolved intermittent errors when loading a Merged Model or multiple single Models from Glue into Navisworks.

### NWC Export

- Resolved an issue where selection of Project Browser options in Revit before NWC export leads to Navisworks geometry errors.

### Roamer

- Redirected Takeoff API and Timeliner API in Roamer config file.